



SHARK TOOTH

TRANSIT HUMP 2



Speed cushions offer a quick and effective traffic calming solution for areas where high speed is frequent.

Transit Humps are manufactured from vulcanized rubber with steel reinforcement, features that offer exceptional strength and wear characteristics. Transit Humps are built rugged enough to be installed permanently and versatile enough to be removed and replaced as needed.



Removal and reinstallation can be accomplished in less than 30 minutes.



Each hump utilizes 4 anchors, 4 bolts and 4 rubber protective bolt caps for proper installation.

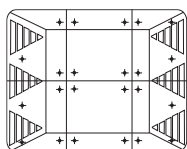

Most common speed cushion layout

TRANSIT HUMPS for superior traffic calming projects.

TRAFFIC CALMING

Aggressive visual “Shark Tooth” reflective triangles help identify a speed cushion’s presence for oncoming vehicles. Their unique design allows transit vehicles, such as buses with wide axles, to pass over the hump without disturbing their passengers. Speed Humps are equipped with reflecting film strips, enhancing day / night visibility.

Pieced together like a puzzle, the Speed Hump can easily cover any large surface by utilizing additional center squares. Humps can also be used for raised pedestrian crosswalks.

Manufactured from vulcanized rubber with steel reinforcement

LEFT EDGE



L 33.5" x W 29.5" x H 2.4"
77 lbs

RIGHT EDGE

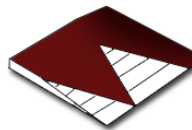

L 35.5" x W 29.5" x H 2.4"
77 lbs

SIDE RAMP

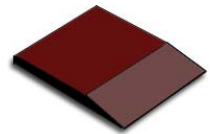

L 33.5" x W 29.5" x H 2.4"
100 lbs



Drill pilot



Drill hole



Clean



Adhesive



Anchor - open to traffic

BENEFITS

- TEMPORARY OR PERMANENT
- INTERCONNECTING
- REFLECTIVE STRIPS
- EASY INSTALLATION
- EXPANDABLE
- TWO COLORS
- ALL WEATHER RESISTANT
- REINFORCED WITH STEEL

Equipped with 20" x 20" Reflective Triangle Bands for improved driver awareness.

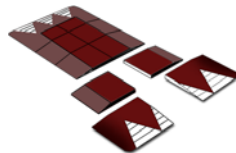

ENHANCE CROSSWALK ZONES

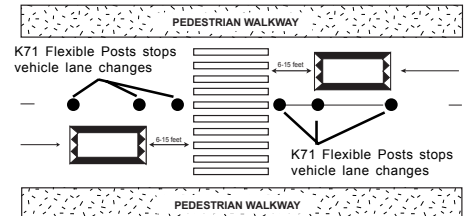

Placement of cushions before and after a crosswalk greatly reduces speeding by motorists.

Font and rear entrance ramps

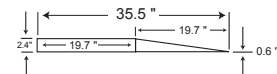

Lateral ramps

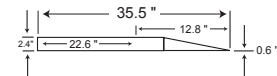

Products include easy to follow Installation instructions

ITEM #	DESCRIPTION	WEIGHT	COLOR	LENGTH	WIDTH	HEIGHT	COST
314-LSK-BLK	Rounded left corner	77Lbs	Black	33.5"	29.5"	2.4"	\$360.00
314-LSK-RED	Rounded left corner	77 Lbs	Red	33.5"	29.5"	2.4"	\$375.00
314-RSK-BLK	Rounded right corner	77 Lbs	Black	23.6"	29.5"	2.4"	\$360.00
314-RSK-RED	Rounded right corner	77 Lbs	Red	23.6"	29.5"	2.4"	\$375.00
314-SSK-BLK	Ramp	100 Lbs	Black	33.5"	39.5"	2.4"	\$305.00
314-SSK-RED	Ramp	100 Lbs	Red	33.5"	39.5"	2.4"	\$335.00
0926-S	Metal pavement sleeve			5 3/4"			\$ 9.90
0926-B	Bolt			2"			\$ 1.25

Installation requires adhesive -
Adhesive is available in 5 oz., 8 oz., 11.1 oz., 27.9 oz. and 37 oz. tubes